

# Breeze

design: arch.Margarita Kroucharska\_Gianni Forcolini



Apparecchio con corpo in alluminio pressofuso per l'illuminazione urbana di piazze e percorsi, spazi verdi pubblici e privati, parchi e giardini. La forma dell'oggetto e' ispirata dal linguaggio organico del mondo naturale - il seme trasportato dal vento, un giovane fusto mosso dalla brezza. E' particolare l'incastro "morbido" tra i due elementi - il palo e il corpo illuminante che crea l'illusione visiva di leggerezza e di libero volo nello spazio. Rispetta la normativa anti-inquinamento luminoso, è disponibile in classe II.

*BREEZE with body made of die-cast aluminium. It is a urban column with one or double heads for use in public environments, parks, parking lots and architectural applications. Wood effect finish available in addition to many different finishes. Dark Sky approved system available in accordance with most restrictive regulations on indirect light control emission. Accessories available include an anchor plate.*

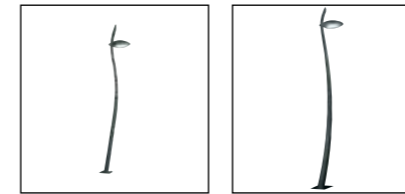

## CERTIFICAZIONI CERTIFICATION



versioni led disponibili: 3000 K / 4000 K  
LEDs available: 3000 K / 4000 K

## GRADO DI PROTEZIONE IP / IK RATING

IP 65  
IP 65

## CLASSE DI ISOLAMENTO CLASSIFICATION

classe I  classe II su richiesta  
class I  class II upon request

## CORPO BODY

alluminio fuso EN AC 44100 alta resistenza all'ossidazione  
cast aluminium EN AC 44100 high resistance to oxidation

## PALO COLUMN

alluminio estruso EN AW 6060 alta resistenza all'ossidazione  
extruded aluminium EN AW 6060 high resistance to oxidation

## DIFFUSORE DIFFUSER

vetro bombato sodico calcico temperato 5 mm  
soda-lime tempered cast glass 5 mm

## RIFLETORE REFLECTOR

alluminio con deposizione in alto vuoto di alluminio purissimo 99,99%  
99.99% pure aluminium high vacuum deposit

## VITERIA ESTERNA EXTERNAL FIXINGS

inox A4-70 trattata in soluzione lubrificante idrorepellente con alto potere antiossidante. Il trattamento assicura la facile apertura del prodotto durante la manutenzione  
stainless steel A4-70 treated with highly antioxidant water-repellent lubricating solution.  
The treatment ensures easy opening of the product for maintenance

## GUARNIZIONI SEALING GASKET

silicone ricotto  
silicone

## CABLAGGIO WIRING

apparecchio fornito con 4m di cavo H07RN8-F pre cablato  
fixture supplied pre-wired cable 4m long H07RN8-F

## LAMPADINA LAMP

esclusa (Led incluso)  
not included (Led integral)

## FINITURA FINISH

verniciatura in polveri poliestere ad alta resistenza ai raggi UV ed alla corrosione  
powder coating polyester high resistance to UV and oxidation



IP65  
 codice colori  
 colour codes  
 .05 grigio antracite  
 anthracite grey  
 .13 grigio chiaro  
 light grey

**1409.203.T.--** 44 W 8 Led 3000 K 5690 lm  
**1409.204.T.--** 44 W 8 Led 4000 K 6340 lm  
 220-240 V 50/60 HZ  
 vetro trasparente *clear diffuser*  
 alimentatore incluso *led driver integral*

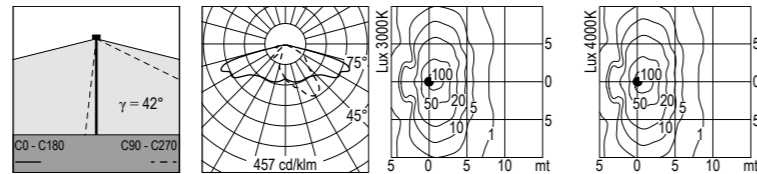

**1409.205.T.--** 44 W 8 Led 3000 K 5690 lm  
**1409.206.T.--** 44 W 8 Led 4000 K 6340 lm  
 220-240 V 50/60 HZ  
 vetro trasparente *clear diffuser*  
 alimentatore incluso *led driver integral*

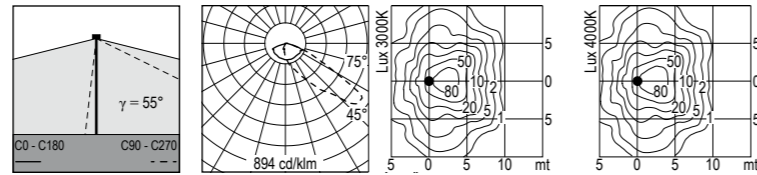

**1409.207.T.--** 44 W 8 Led 3000 K 5690 lm  
**1409.208.T.--** 44 W 8 Led 4000 K 6340 lm  
 220-240 V 50/60 HZ  
 vetro trasparente *clear diffuser*  
 alimentatore incluso *led driver integral*

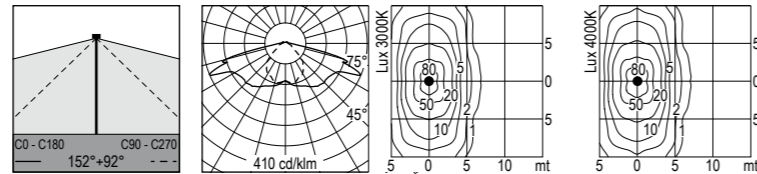

IP65  
 codice colori  
 colour codes  
 .05 grigio antracite  
 anthracite grey  
 .13 grigio chiaro  
 light grey  
 \*  
 classe II su richiesta  
 class II upon request

**1409.B2F.T.--** 35 W HIT G12 3300 lm  
 220-240 V 50/60 HZ  
 vetro trasparente *clear diffuser*  
 alimentatore elettronico incluso  
*electronic ballast integral*

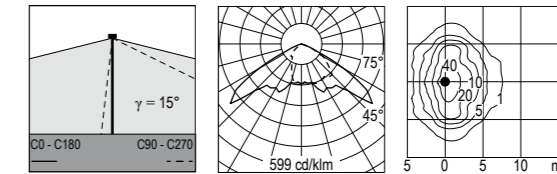

**1409.N1F.T.--** 70 W HIT G12 6600 lm  
 220-240 V 50/60 HZ  
 vetro trasparente *clear diffuser*  
 alimentatore elettronico incluso  
*electronic ballast integral*

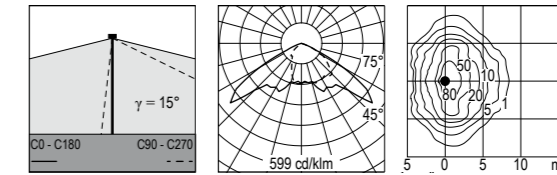

**1409.21F.T.--** 150 W HIT G12 14000 lm  
 230 V 50 HZ  
 vetro trasparente *clear diffuser*  
 alimentatore ferromagnetico incluso  
*conventional ballast integral*

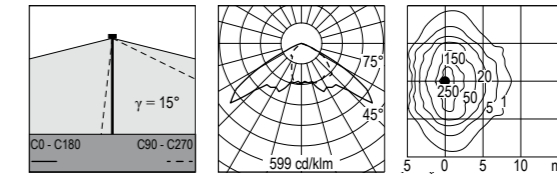

## Accessori Accessories

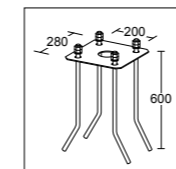

**429**  
 Base di ancoraggio + tiranti da cementare  
*Plated steel anchorage for concreting*

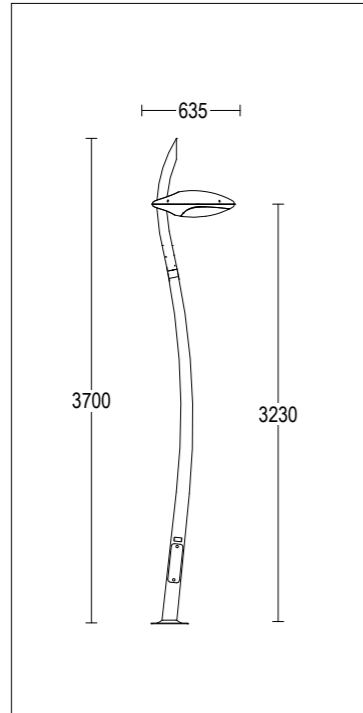

IP65  
 codice colori  
 colour codes  
 .05 grigio antracite  
 anthracite grey  
 .13 grigio chiaro  
 light grey

**1409.59F.A.--** 70 W HIT-DE /  
 HST-DE Rx7s 6600 lm  
 230 V 50 HZ  
 vetro acidato *acid etched diffuser*  
 alimentatore ferromagnetico incluso  
*conventional ballast integral*

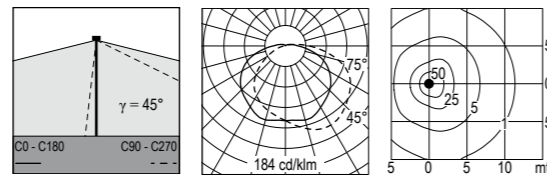

**1409.61F.A.--** 150 W HIT-DE /  
 HST-DE Rx7s 14000 lm  
 230 V 50 HZ  
 vetro acidato *acid etched diffuser*  
 alimentatore ferromagnetico incluso  
*conventional ballast integral*

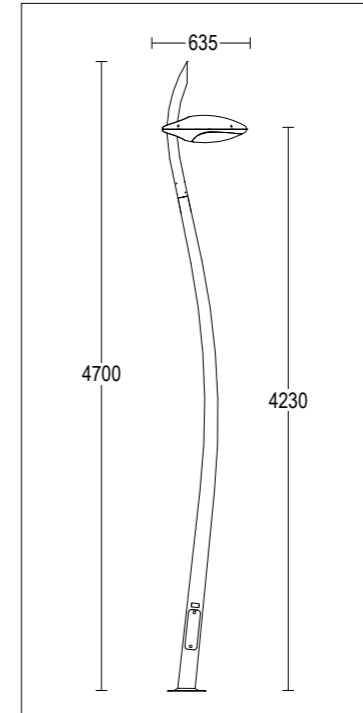
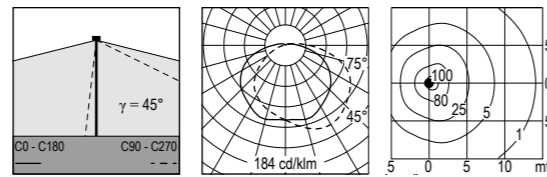

IP65  
 codice colori  
 colour codes  
 .05 grigio antracite  
 anthracite grey  
 .13 grigio chiaro  
 light grey

**1405.203.T.--** 44 W 8 Led 3000 K 5690 lm  
**1405.204.T.--** 44 W 8 Led 4000 K 6340 lm  
 220-240 V 50/60 HZ  
 vetro trasparente *clear diffuser*  
 alimentatore incluso *led driver integral*

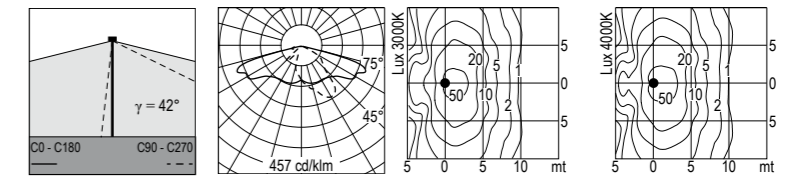

**1405.205.T.--** 44 W 8 Led 3000 K 5690 lm  
**1405.206.T.--** 44 W 8 Led 4000 K 6340 lm  
 220-240 V 50/60 HZ  
 vetro trasparente *clear diffuser*  
 alimentatore incluso *led driver integral*

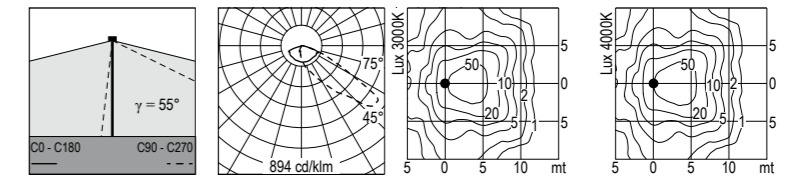

**1405.207.T.--** 44 W 8 Led 3000 K 5690 lm  
**1405.208.T.--** 44 W 8 Led 4000 K 6340 lm  
 220-240 V 50/60 HZ  
 vetro trasparente *clear diffuser*  
 alimentatore incluso *led driver integral*

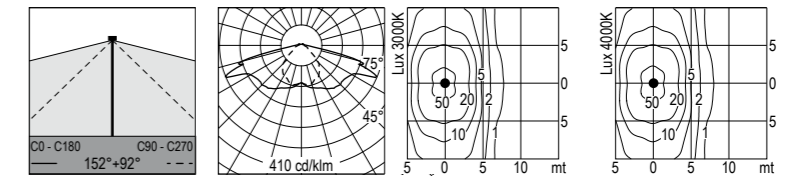

## Accessori Accessories

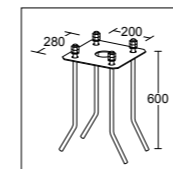

**429**  
 Base di ancoraggio + tiranti da cementare  
*Plated steel anchorage for concreting*

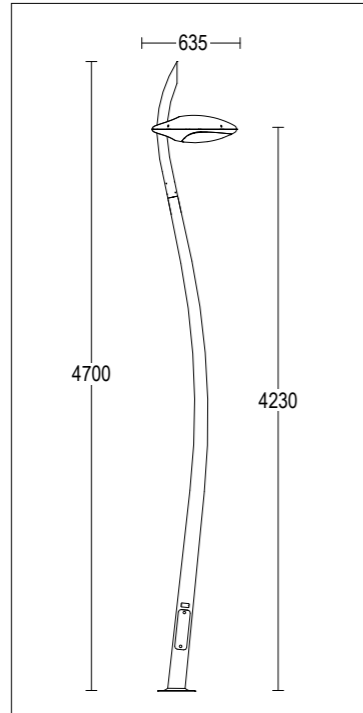

IP65  
 \*  
 classe II su richiesta  
*class II upon request*

codice colori  
 colour codes  
 .05 grigio antracite  
 anthracite grey  
 .13 grigio chiaro  
 light grey

**1405.B2F.T.--** 35 W HIT G12 3300 lm  
 220-240 V 50/60 HZ  
 vetro trasparente *clear diffuser*  
 alimentatore elettronico incluso  
*electronic ballast integral*

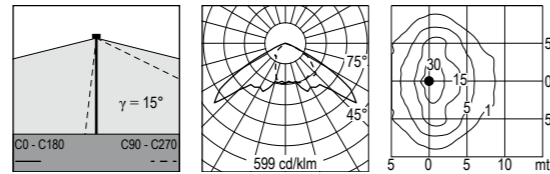

**1405.N1F.T.--** 70 W HIT G12 6600 lm  
 220-240 V 50/60 HZ  
 vetro trasparente *clear diffuser*  
 alimentatore elettronico incluso  
*electronic ballast integral*

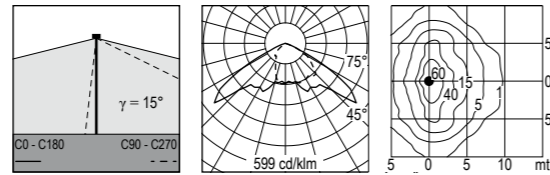

**1405.21F.T.--** 150 W HIT G12 14000 lm  
 230 V 50 HZ  
 vetro trasparente *clear diffuser*  
 alimentatore ferromagnetico incluso  
*conventional ballast integral*

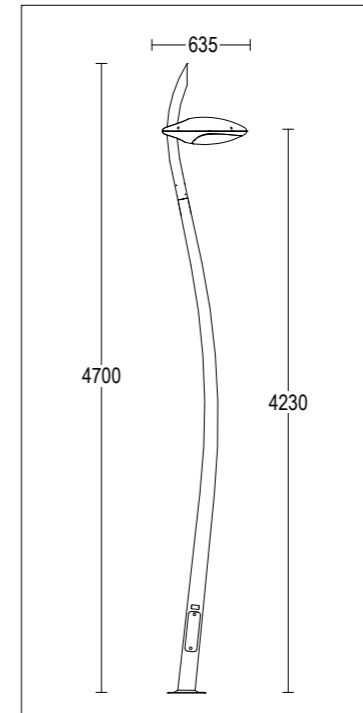
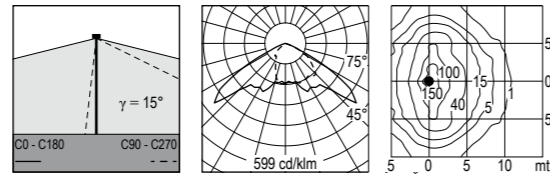

IP65  
 classe II su richiesta  
*class II upon request*

codice colori  
 colour codes  
 .05 grigio antracite  
 anthracite grey  
 .13 grigio chiaro  
 light grey

**1405.59F.A.--** 70 W HIT-DE /  
 HST-DE Rx7s 6600 lm  
 230 V 50 HZ  
 vetro acidato *acid etched diffuser*  
 alimentatore ferromagnetico incluso  
*conventional ballast integral*

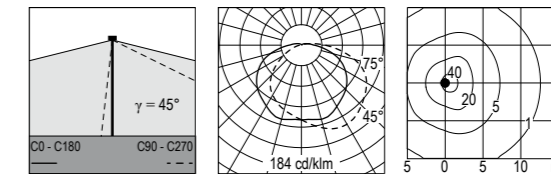

**1405.61F.A.--** 150 W HIT-DE /  
 HST-DE Rx7s 14000 lm  
 230 V 50 HZ  
 vetro acidato *acid etched diffuser*  
 alimentatore ferromagnetico incluso  
*conventional ballast integral*

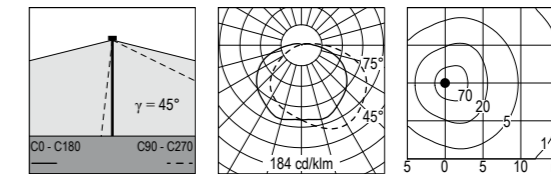

## Accessori Accessories

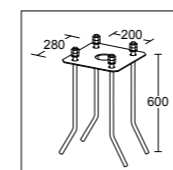

**429**  
 Base di ancoraggio + tiranti da cementare  
*Plated steel anchorage for concreting*

