

# Tret Up

design: arch.Margarita Kroucharska\_Gianni Forcolini



Tret Up illumina percorsi pedonali in aree pubbliche e residenziali. Il design è sobrio ed essenziale, adeguato a inserimenti armonici nel contesto ambientale. La linea è costituita da elementi realizzati in alluminio pressofuso ed estruso. La possibilità di accostarli in soluzioni differenti, in cui si fondono, nella forma, le sensazioni trasmesse dai diversi materiali, consente di ottenere risultati estetici personalizzati e unici. Disponibile nella versione anti-inquinamento luminoso.

*Tret Up is made of die-cast aluminium. An organically shaped column mounted light with internal anti-glare louvre for use in public paths, pedestrian areas, parks or architectural applications. Available for a round or triangular column. Wood effect finish available in addition to many different finishes. Accessories available include an anchorage base. Light performance in accordance with indirect light control emission regulations.*

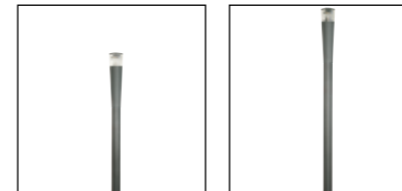

## CERTIFICAZIONI CERTIFICATION



versioni led disponibili: 3000 K / 4000 K  
LEDs available: 3000 K / 4000 K

## GRADO DI PROTEZIONE IP / IK RATING

IP 65 / IK 10  
IP 65 / IK 10

## CLASSE DI ISOLAMENTO CLASSIFICATION

classe I  classe II su richiesta  
class I  class II upon request

## CORPO BODY

alluminio fuso EN AC 44200 alta resistenza all'ossidazione  
cast aluminium EN AC 44200 high resistance to oxidation

## PALO COLUMN

alluminio estruso EN AW 6060 alta resistenza all'ossidazione  
extruded aluminium EN AW 6060 high resistance to oxidation

## DIFFUSORE DIFFUSER

policarbonato trasparente resistente all'urto e ai raggi UV  
vandal proof clear polycarbonate UV resistant

## VITERIA ESTERNA

### EXTERNAL FIXINGS

inox A4-70 trattata in soluzione lubrificante idrorepellente con alto potere antiossidante. Il trattamento assicura la facile apertura del prodotto durante la manutenzione.  
stainless steel A4-70 treated with highly antioxidant water-repellent lubricating solution. The treatment ensures easy opening of the product for maintenance.

## GUARNIZIONI SEALING GASKET

silicone ricotto  
silicone

## CABLAGGIO WIRING

apparecchio fornito con 3,2m di cavo H07RN8-F pre cablato  
fixture supplied pre-wired cable 3.3m long H07RN8-F

## LAMPADINA LAMP

esclusa (Led incluso)  
not included (Led integral)

## FINITURA FINISH

verniciatura in polveri poliestere ad alta resistenza ai raggi UV ed alla corrosione  
powder coating polyester high resistance to UV and oxidation

# Tret Up

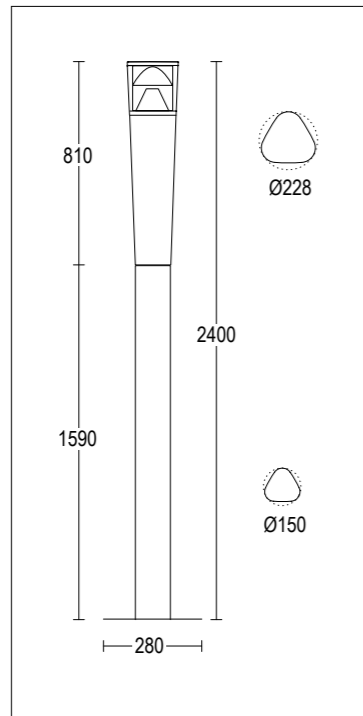

- IP65 codice colori  
colour codes
- .05** grigio antracite  
anthracite grey
- .13** grigio chiaro  
light grey
- IK10
- classe II su richiesta  
class II upon request

**8280.CDF.T.--** 39 W 1 Led 3000 K 3765 lm  
**8280.CHF.T.--** 39 W 1 Led 4000 K 3932 lm  
 220-240 V 50/60 HZ  
 Policarbonato trasparente *clear polycarbonate*  
 alimentatore incluso *led driver integral*

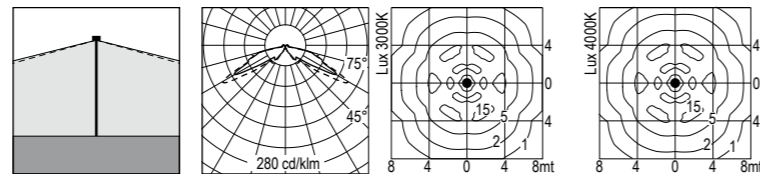

**8280.19F.T.--** 70 W HIT G12 6600 lm  
 230 V 50 HZ  
 policarbonato trasparente *clear polycarbonate*  
 alimentatore ferromagnetico incluso  
*conventional ballast integral*

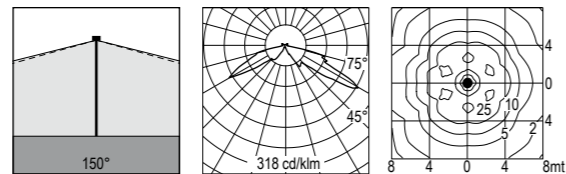

# Tret Up

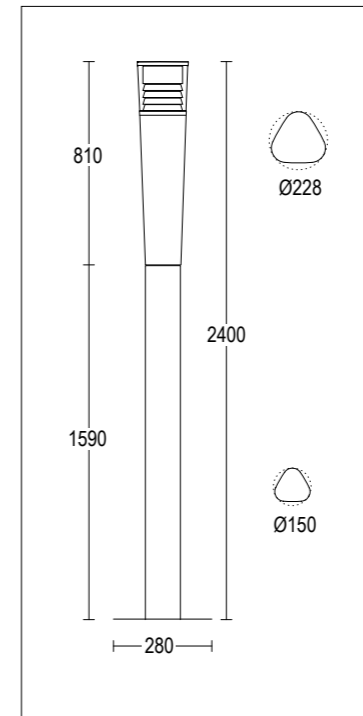

- IP65 codice colori  
colour codes
- .05** grigio antracite  
anthracite grey
- .13** grigio chiaro  
light grey
- IK10
- classe II su richiesta  
class II upon request
- \*

**8282.19F.T.--** 70 W HIT G12 6600 lm  
 230 V 50 HZ  
 policarbonato trasparente *clear polycarbonate*  
 alimentatore ferromagnetico incluso  
*conventional ballast integral*

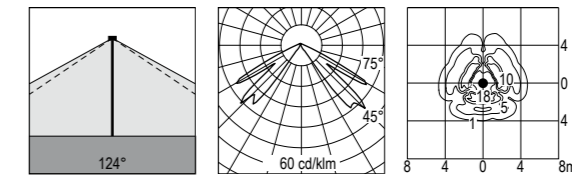

## Accessori Accessories

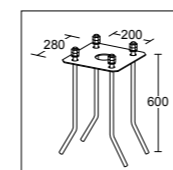

**429**  
 Base di ancoraggio + tiranti da cementare  
*Plated steel anchorage for concreting*

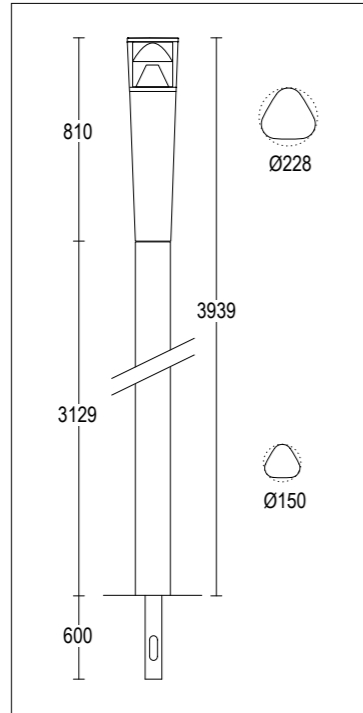

IP65 codice colori  
colour codes

**.05** grigio antracite  
anthracite grey

**.13** grigio chiaro  
light grey

IK10

classe II su richiesta  
class II upon request

**8284.CDF.T.--** 39 W 1 Led 3000 K 3765 lm  
**8284.CHF.T.--** 39 W 1 Led 4000 K 3932 lm  
 220-240 V 50/60 HZ  
 Policarbonato trasparente *clear polycarbonate*  
 alimentatore incluso *led driver integral*

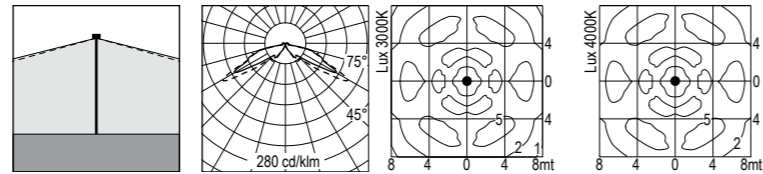

**8284.19F.T.--** 70 W HIT G12 6600 lm  
 230 V 50 HZ  
 Policarbonato trasparente *clear polycarbonate*  
 alimentatore ferromagnetico incluso  
*conventional ballast integral*

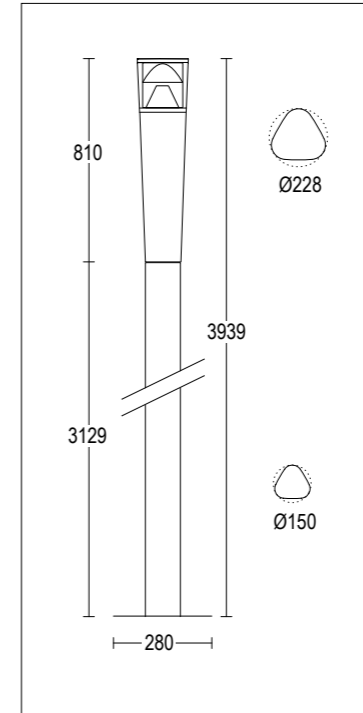
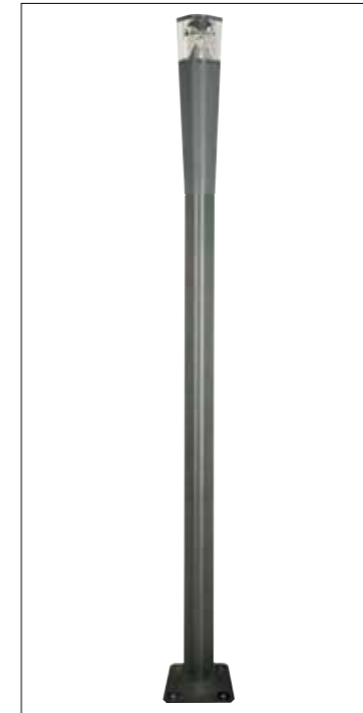
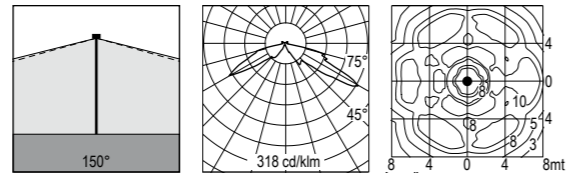

IP65 codice colori  
colour codes

**.05** grigio antracite  
anthracite grey

**.13** grigio chiaro  
light grey

IK10

classe II su richiesta  
class II upon request

**8285.CDF.T.--** 39 W 1 Led 3000 K 3765 lm  
**8285.CHF.T.--** 39 W 1 Led 4000 K 3932 lm  
 230 V 50 HZ  
 Policarbonato trasparente *clear polycarbonate*  
 alimentatore incluso *led driver integral*

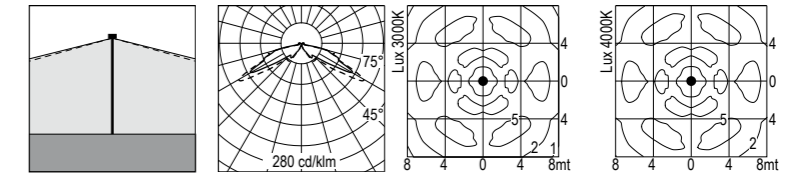

**8285.19F.T.--** 70 W HIT G12 6600 lm  
 230 V 50 HZ  
 Policarbonato trasparente *clear polycarbonate*  
 alimentatore ferromagnetico incluso  
*conventional ballast integral*

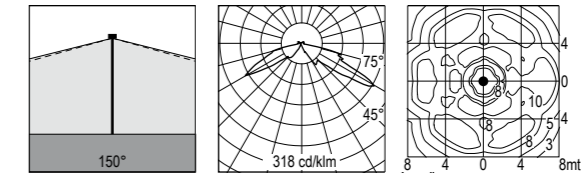

## Accessori Accessories

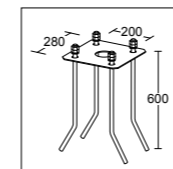

**429**  
 Base di ancoraggio + tiranti da cementare  
*Plated steel anchorage for concreting*